

Y-Bearing Flanged Units With Round Pressed Steel Housing "C"

UEC 204 2S

Y-Bearing Flanged Units With Round Pressed Steel Housing "C"

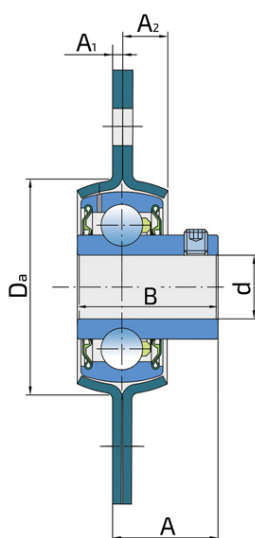
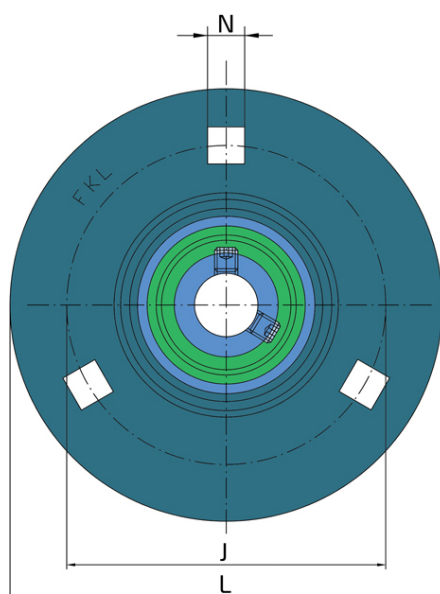

Technical Specification

d	Bore diameter	20 mm
B	Width inner ring	25.5 mm
Da	Centering diameter	55 mm
L	Diameter of housings	91 mm
A	Distance from the housing flange to the front of the inner ring of the bearing	20.3 mm
A1	Housing flange thickness	2 mm
A2	Half-housing width	8 mm
J	Pitch circle diameter	71.5 mm
N	Length of attachment bolt square hole	8.7 mm
Fr	Radial load	3.3 kN
Fa	Axial load	1.6 kN
kg	Mass	0.28 kg
Cdyn	Dynamic load rating	12.7 kN
Co	Static load rating	6.55 kN
Pu	Fatigue load limit	0.28 kN

Sealing

S SEAL / S SEAL (2S)

Single lip seal with the labyrinth between the sheet part and the rubber lip which conducts the contact sealing. The friction and speeds are the same as with RS but provides much better protection against the rough impurity particles. This is very good sealing system: the sheet part protects the seal from the soil, dust and rough particles. At the same time makes the labyrinth with the rubber part. The rubber part provides contact sealing which prevents penetration of finer impurities, water, moisture, steam etc. Suitable for neutral conditions because of the presence of the foreign materials. It is used with the Y bearing (standard) and deep groove ball bearings.

