

# Y-Ball Bearings With Integral Adapter Sleeve

## UH 209/35 2S.SH

Y-Ball Bearings With Integral Adapter Sleeve  
Harvester

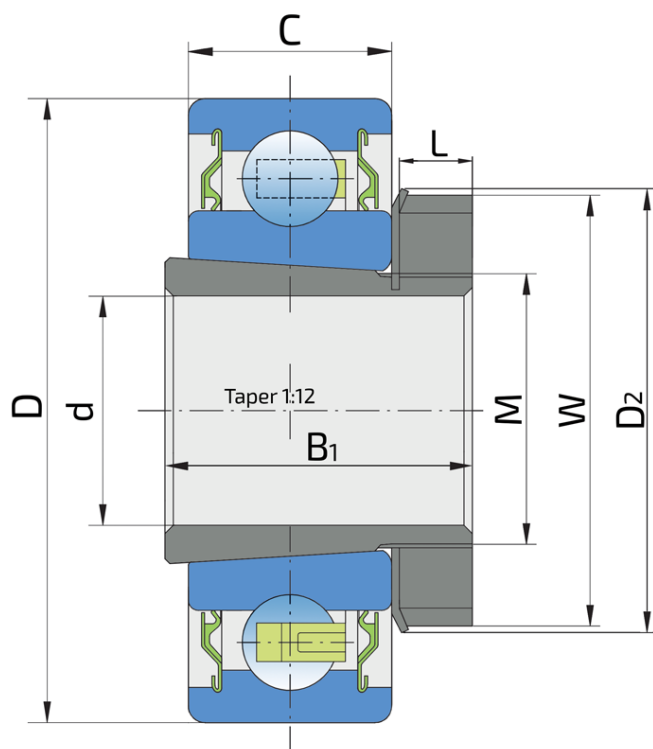

### Technical Specification

d	Bore diameter	35 mm
D	Outside diameter	85 mm
W	KM nut outside diameter	58 mm
D2	MB Washer outside diameter	62 mm
B1	Width adapter sleeve	36 mm
C	Width outer ring	23 mm
L	KM nut width	9 mm
M	Thread adapter sleeve	40x1.5 mm
kg	Mass	0.7 kg
Cdyn	Dynamic load rating	33.2 kN
Co	Static load rating	21.6 kN
Pu	Fatigue load limit	0.915 kN

## Sealing

---

### S SEAL / S SEAL (2S)

Single lip seal with the labyrinth between the sheet part and the rubber lip which conducts the contact sealing. The friction and speeds are the same as with RS but provides much better protection against the rough impurity particles. This is very good sealing system: the sheet part protects the seal from the soil, dust and rough particles. At the same time makes the labyrinth with the rubber part. The rubber part provides contact sealing which prevents penetration of finer impurities, water, moisture, steam etc. Suitable for neutral conditions because of the presence of the foreign materials. It is used with the Y bearing (standard) and deep groove ball bearings.

