

The Bearing Solution For Seeding Machines, Integrated Flange

IL20-80/6T-M16x2

The Bearing Solution For Seeding Machines, Integrated Flange
Seeding Machine

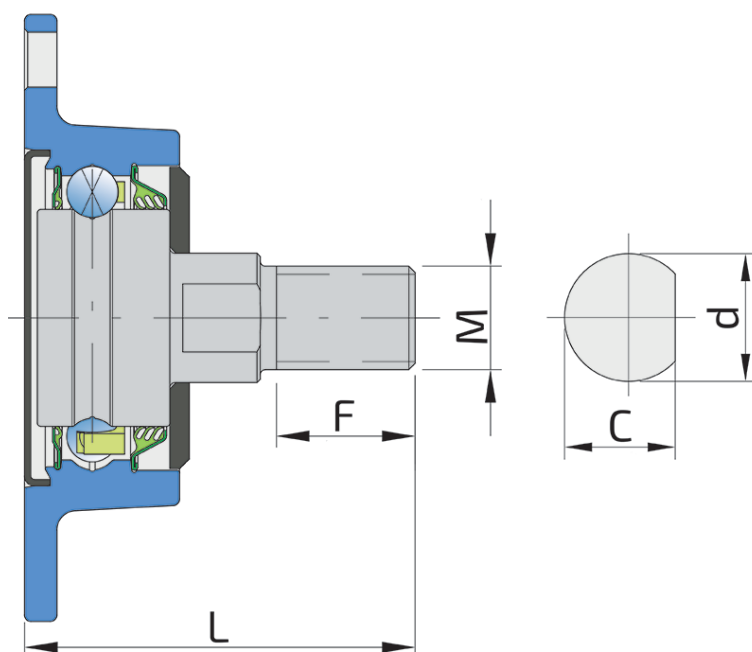

Technical Specification

| | | |
|------|--------------------------------|--------------|
| J | Pitch circle diameter | 80 mm |
| D | Outside diameter | 94 mm |
| H/T | Hole/Thread | 6xM8x1.25 mm |
| d | Bore diameter | 20 mm |
| C | D-shape hole cut out dimension | 18.5 mm |
| M | Outer Thread | M16x2 mm |
| L | Total length | 71.6 mm |
| L1 | Total flange length | 38 mm |
| E | Length of D shape | 12.4 mm |
| F | Length of threaded part | 21.2 mm |
| kg | Mass | 0.73 kg |
| Cdyn | Dynamic load rating | 22 kN |
| Co | Static load rating | 15.2 kN |
| Pu | Fatigue load limit | 0.64 kN |

Sealing

SHEET METAL SHIELD+S SEAL / T SEAL+STEEL PLATE

Sheet metal shield and S seal on the base side and 3-lip seal with Steel plate on the front side which is exposed to contaminants.

Sheet metal shield and S seal together with attached disc eliminates the possibility of contamination from the base side.

The 3-lip seal on the front side protects the bearing from contaminant penetration.

The Steel plate protects the seal from mechanical damage.

