

Bearing Unit

ZGKU 208 2S

Bearing Unit

Cage roller, packer roller, spike roller, rice field roller

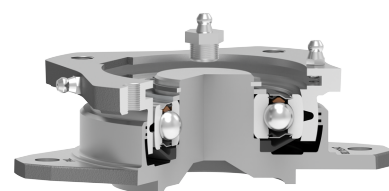
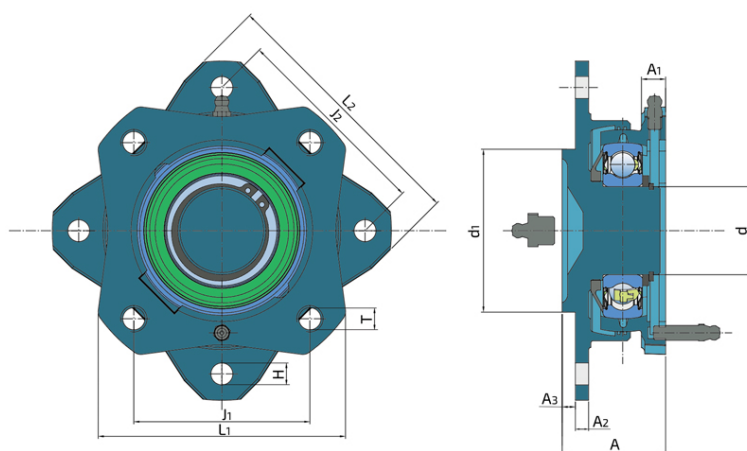

Technical Specification

d	Bore diameter	40 mm
d1	Centering diameter	74 mm
J1	Distance between the holes	80 mm
L1	Housing overall width	112 mm
J2	Distance between the holes	92 mm
L2	Housing overall width	120 mm
A	Overall unit width	47 mm
A1	Flange width	11 mm
A2	Flange width	6 mm
A3	Centering diameter height	6 mm
T	Threaded hole size	4xM12x1.25 mm
H	Hole diameter	4x10 mm
kg	Mass	2.3 kg
Cdyn	Dynamic load rating	32.5 kN
Co	Static load rating	19.8 kN
Pu	Fatigue load limit	0.832 kN

Sealing

S SEAL / S SEAL (2S)

Single lip seal with the labyrinth between the sheet part and the rubber lip which conducts the contact sealing. The friction and speeds are the same as with RS but provides much better protection against the rough impurity particles. This is very good sealing system: the sheet part protects the seal from the soil, dust and rough particles. At the same time makes the labyrinth with the rubber part. The rubber part provides contact sealing which prevents penetration of finer impurities, water, moisture, steam etc. Suitable for neutral conditions because of the presence of the foreign materials. It is used with the Y bearing (standard) and deep groove ball bearings.

