

Ball Bearing

SLE 206-103 2F

Ball Bearing

Mower

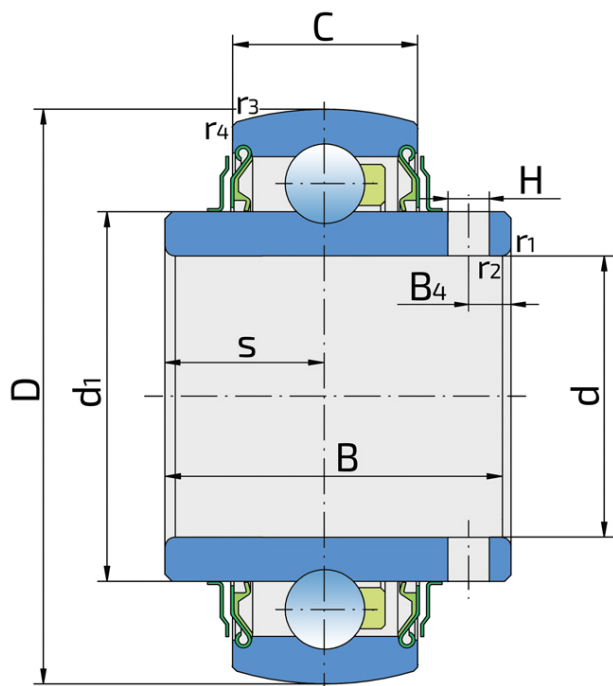

Technical Specification

d	Bore diameter	30.162 mm
D	Outside diameter	62 mm
B	Width inner ring	38.1 mm
C	Width outer ring	18 mm
s	Distance from inner ring side face to raceway centre	15.9 mm
d1	Outer diameter inner ring	39.7 mm
B4	Distance face to hole center	5.5 mm
H	Hole diameter	7 mm
r1,2	Inner ring Chamfer dimension	0.6 mm
r3,4	Outside ring Chamfer dimension	0.8 mm
C _{dyn}	Dynamic load rating	19.5 kN
C _o	Static load rating	11.3 kN
P _u	Fatigue load limit	0.475 kN
kg	Mass	0.28 kg

Sealing

F SEAL / F SEAL (2F)

Dual sealing, protection cover placed on the inner ring protects against rough impurity particles and makes the labyrinth with the sheet part of the seal; then the sealing S type, with the labyrinth between the sheet part and the rubber lip that conducts the contact sealing. The friction and speeds are the same as with S but has much better protection against rough impurity particles. It is very good sealing system: the sheet part protects the seal from the soil, dust and rough particles. At the same time makes the labyrinth with the rubber part. The rubber part provides the contact sealing that prevents the penetration of the finer impurities, water, moisture, steam etc. Suitable for heavier conditions due to better protection against foreign matters. It is used with the Y bearings (standard).

