

# Y-Ball Bearings with Standard Inner Ring

## US 211 2S.T.C23

Y-Ball Bearings with Standard Inner Ring

Harvester

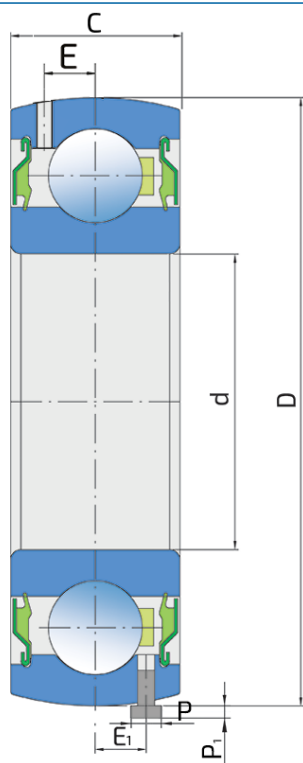

### Technical Specification

|      |  |          |
|------|--|----------|
| d    | Bore diameter  | 55 mm    |
| D    | Outside diameter   | 100 mm   |
| C    | Width outer ring   | 23 mm    |
| B    | Width inner ring   | 23 mm    |
| E    | Distance from raceway centre to the hole for lubrication | 7 mm     |
| E1   | Distance from raceway center to the stopping pin         | 7 mm     |
| P    | Stopping pin diameter                                    | 3 mm     |
| P1   | Stopping pin high  | 2 mm     |
| kg   | Mass   | 0.6 kg   |
| Cdyn | Dynamic load rating                                      | 43.5 kN  |
| Co   | Static load rating                                       | 29 kN    |
| Pu   | Fatigue load limit                                       | 0.865 kN |

## Sealing

---

### S SEAL / S SEAL (2S)

Single lip seal with the labyrinth between the sheet part and the rubber lip which conducts the contact sealing. The friction and speeds are the same as with RS but provides much better protection against the rough impurity particles. This is very good sealing system: the sheet part protects the seal from the soil, dust and rough particles. At the same time makes the labyrinth with the rubber part. The rubber part provides contact sealing which prevents penetration of finer impurities, water, moisture, steam etc. Suitable for neutral conditions because of the presence of the foreign materials. It is used with the Y bearing (standard) and deep groove ball bearings.

