

Y-Ball Bearings With Integral Adapter Sleeve

UH 217/70 2S.H.T

Y-Ball Bearings With Integral Adapter Sleeve
Harvester

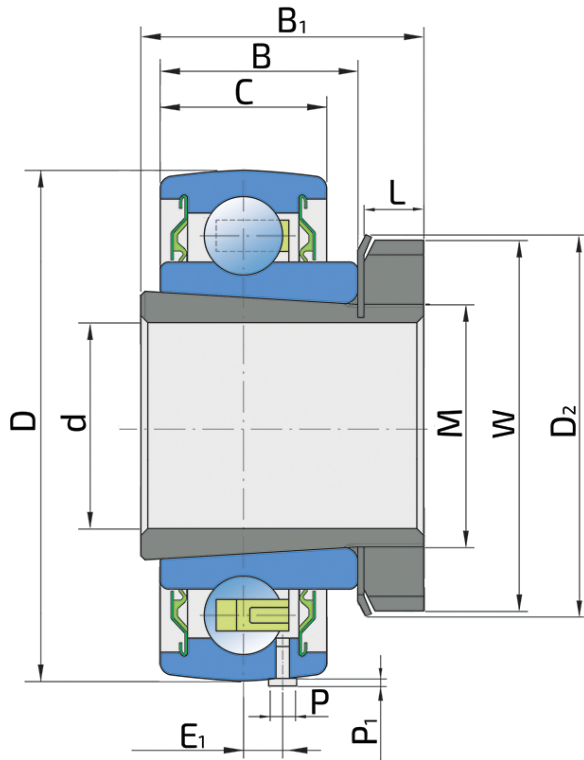

Technical Specification

d	Bore diameter	70 mm
D	Outside diameter	150 mm
W	KM nut outside diameter	105 mm
D2	MB Washer outside diameter	112 mm
B	Width inner ring	45 mm
B1	Width adapter sleeve	70 mm
C	Width outer ring	39 mm
L	KM nut width	15 mm
E1	Distance from raceway center to the stopping pin	12 mm
M	Thread adapter sleeve	M80x2 mm
P	Stopping pin diameter	5 mm
P1	Stopping pin high	2.8 mm
kg	Mass	3.87 kg
Cdyn	Dynamic load rating	85 kN
Co	Static load rating	65 kN
Pu	Fatigue load limit	2.73 kN

Sealing

S SEAL / S SEAL (2S)

Single lip seal with the labyrinth between the sheet part and the rubber lip which conducts the contact sealing. The friction and speeds are the same as with RS but provides much better protection against the rough impurity particles. This is very good sealing system: the sheet part protects the seal from the soil, dust and rough particles. At the same time makes the labyrinth with the rubber part. The rubber part provides contact sealing which prevents penetration of finer impurities, water, moisture, steam etc. Suitable for neutral conditions because of the presence of the foreign materials. It is used with the Y bearing (standard) and deep groove ball bearings.

