

Y-Ball Bearings With Integral Adapter Sleeve

UH 211HD/50 2S.H.T

Y-Ball Bearings With Integral Adapter Sleeve
Harvester

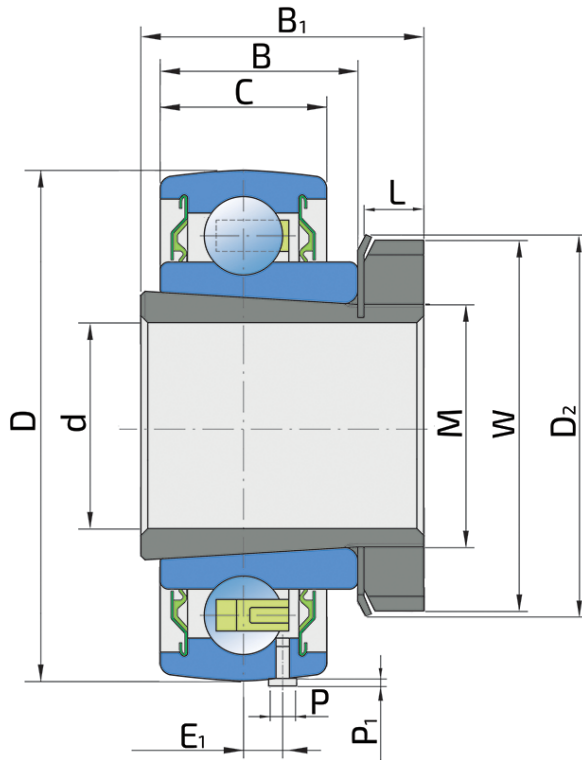

Technical Specification

d	Bore diameter	50 mm
D	Outside diameter	100 mm
W	KM nut outside diameter	75 mm
D2	MB Washer outside diameter	81 mm
B	Width inner ring	25 mm
B1	Width adapter sleeve	45 mm
C	Width outer ring	25 mm
L	KM nut width	11 mm
E1	Distance from raceway center to the stopping pin	7 mm
M	Thread adapter sleeve	55x2 mm
P	Stopping pin diameter	3 mm
P1	Stopping pin high	2 mm
kg	Mass	1.16 kg
Cdyn	Dynamic load rating	48.8 kN
Co	Static load rating	31.75 kN
Pu	Fatigue load limit	1.334 kN

Sealing

S SEAL / S SEAL (2S)

Single lip seal with the labyrinth between the sheet part and the rubber lip which conducts the contact sealing. The friction and speeds are the same as with RS but provides much better protection against the rough impurity particles. This is very good sealing system: the sheet part protects the seal from the soil, dust and rough particles. At the same time makes the labyrinth with the rubber part. The rubber part provides contact sealing which prevents penetration of finer impurities, water, moisture, steam etc. Suitable for neutral conditions because of the presence of the foreign materials. It is used with the Y bearing (standard) and deep groove ball bearings.

