

The Bearing Solution For Seeding Machines, Integrated Flange

IL20S-76.2/6H-B16-29.175

The Bearing Solution For Seeding Machines, Integrated Flange
Seeding Machine

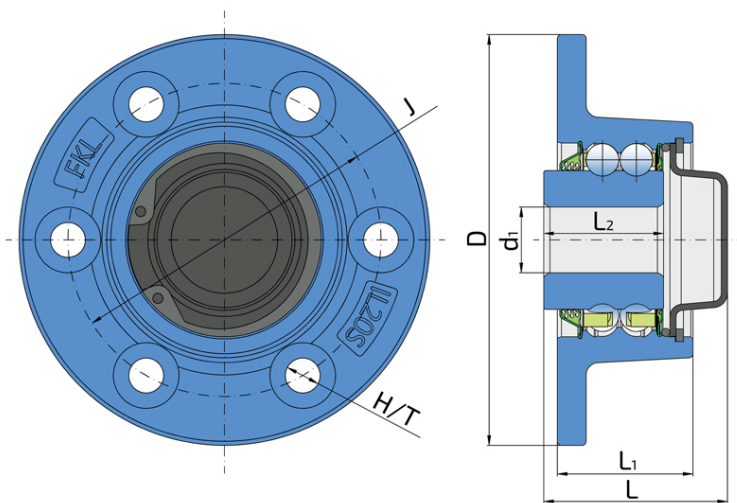

Technical Specification

J	Pitch circle diameter	76.2 mm
D	Outside diameter	100 mm
H/T	Hole/Thread	6x8.5 mm
d1	Bore diameter	16 mm
L	Total length	44.7 mm
L1	Total flange length	33 mm
L2	Bearing width	29.175 mm
kg	Mass	0.758 kg
Cdyn	Dynamic load rating	22 kN
Co	Static load rating	15.2 kN
Pu	Fatigue load limit	0.638 kN

Sealing

T SEAL / S SEAL + O-RING + PLASTIC CAP

T seal on the base side and S seal with O-ring and Plastic cap on the front side which is exposed to the environment. Plastic cap protects the nut and reduces the penetration of contaminants.

