

# Bearing Unit

## LEFN 209 2T.H

Bearing Unit  
Universal Solution

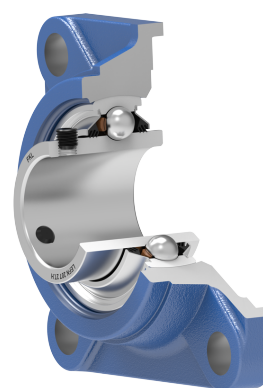
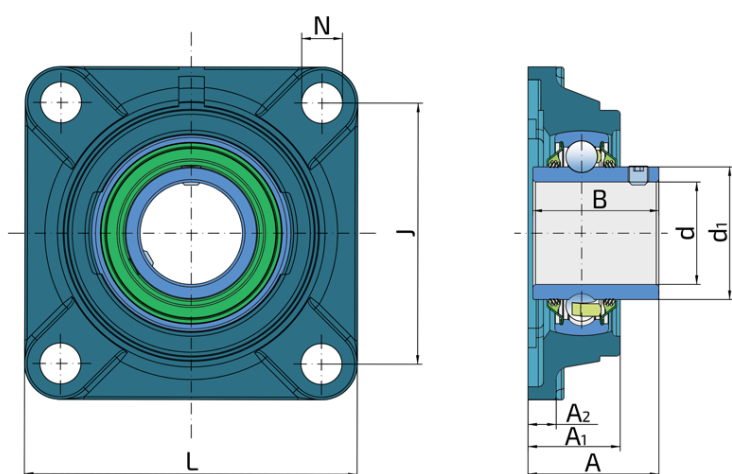

### Technical Specification

d	Bore diameter	45 mm
d1	Outer diameter inner ring	56.6 mm
L	Total length	137 mm
J	Distance between the holes	105 mm
N	Hole diameter	16 mm
A	Overall width	52.2 mm
A1	Total housing width	38 mm
A2	Housing flange thickness	12 mm
B	Width inner ring	49.2 mm
kg	Mass	2.25 kg
Cdyn	Dynamic load rating	32.5 kN
Co	Static load rating	20.4 kN
Pu	Fatigue load limit	0.857 kN

## Sealing

---

### T SEAL / T SEAL (2T)

3-lip seal on the both side of the bearing, provides equal protection against contamination. Recommended for application where the possibility of contamination is the same on the both side.

