

Y-Ball Bearings with Integral Adapter Sleeve

UH 209/30 2T.SH

Y-Ball Bearings with Integral Adapter Sleeve

Harvester

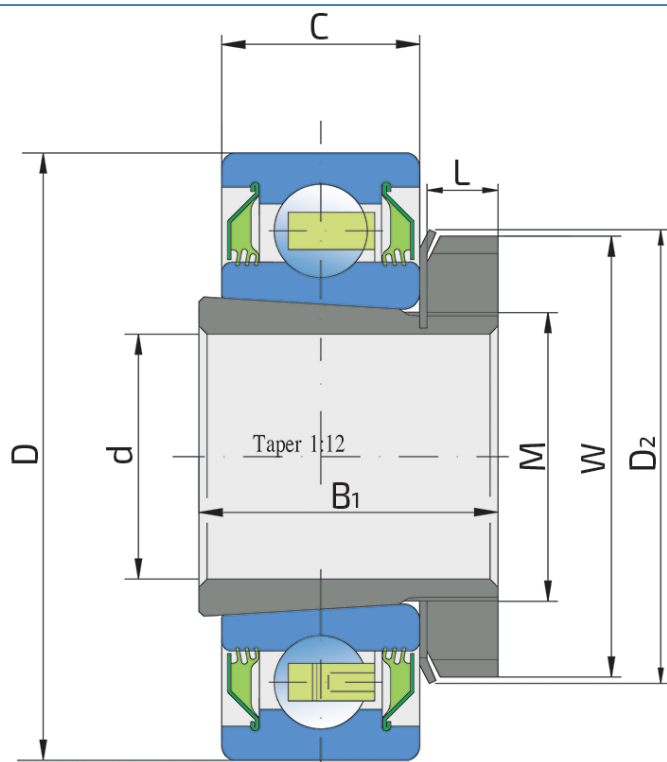

Technical Specification

d	Bore diameter	30 mm
D	Outside diameter	85 mm
W	KM nut outside diameter	52 mm
D2	MB Washer outside diameter	57 mm
B1	Width adapter sleeve	35 mm
C	Width outer ring	23 mm
L	KM nut width	8 mm
M	Thread adapter sleeve	35x1.5 mm
kg	Mass	0.7 kg
Cdyn	Dynamic load rating	33.2 kN
Co	Static load rating	21.6 kN
Pu	Fatigue load limit	0.91 kN

Sealing

T SEAL / T SEAL (2T)

3-lip seal on the both side of the bearing, provides equal protection against contamination. Recommended for application where the possibility of contamination is the same on the both side.

